

# Sapphire™ Multi-Therapy Patient Guide



This information does not replace the official instruction for use



# Table of Content

---

Important Patient Information .....	3
Getting to know Your Pump.....	4
Getting Started .....	5
Priming The Tubing Set .....	7
Starting Infusion (Repeat Last).....	8
Stop & Resume Infusion.....	9
Restart Infusion With a New Bag .....	10
Ending Infusion.....	11
Charging The Pump .....	12
Troubleshooting Alarms .....	13
Warnings.....	14



# Important Patient Information

---

Patient name: \_\_\_\_\_

Medication (name and dose): \_\_\_\_\_

## Sapphire pump settings

Delivery mode: \_\_\_\_\_

Flow rate: \_\_\_\_\_

Volume to be infused (VTBI): \_\_\_\_\_

Length of the infusion: \_\_\_\_\_

Other settings: \_\_\_\_\_

**⚠ Stop the pump and immediately contact your healthcare provider, if you have any of the following side effects:**

---

---

Special instructions:

---

---

# Infusion System Overview

---

- 1 Medication bag
- 2 Tubing
- 3 Sapphire pump



# Getting to know your pump

## Sapphire Pump Overview



## Sapphire Pump Tubing Set

There are different types of tubing sets. The tubing set you are using may have some or all of these parts.

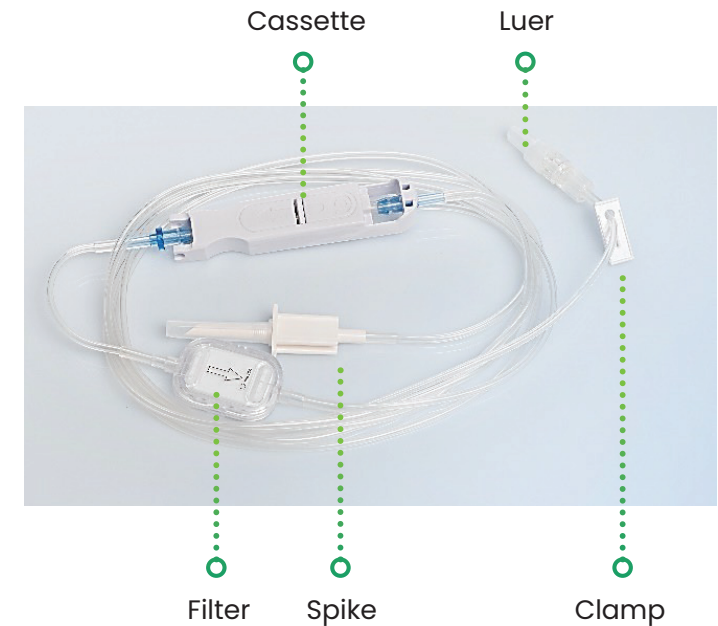

# Getting Started



## Turn pump on

Press the **ON/OFF** key below the screen.

The pump performs a system check.



## Open door

Press your thumb against the marked area of the door. Swing the safety door outwards while pressing.



## Close door

Swing the safety door inwards to close the door, you should hear a click.



If the pump/display does not turn on as expected, or if the hard keys do not work as expected, do not use the pump and contact your healthcare provider.



# Insert The Cassette

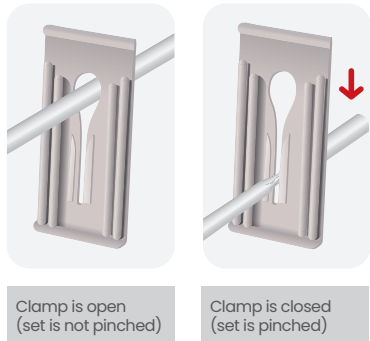

1. Closing all tubing set clamps.



2. Insert the cassette at an angle.



3. Clip the top of the cassette into the **Lock**. You should hear a click.



4. Close the door, you should hear a click.

*Check the arrow on the cassette points down from the bag to the open end.*



# Priming The Tubing Set

Priming is the process used to fill the tubing set with medication, removing all air from the tubing. Your healthcare provider may have already primed the tubing for you, in case your healthcare provider did not prime the tubing:

1. Verify the tubing set is disconnected from your catheter/ access site.

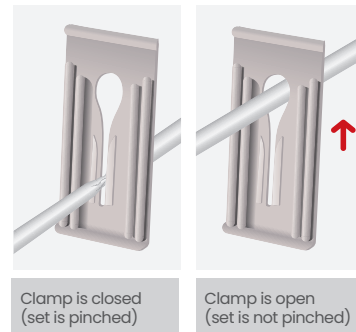

2. Open all tubing clamps. Make sure there are no other occlusions blocking the tubing set.



3. Remove tubing end cap and save for later. **Do not** touch the end of the tubing to prevent contamination.



4. On the pump's startup screen, press "Prime".



5. Make sure the tubing set is not connected to you, and press "Prime".



6. The pump shows a countdown timer for the priming to end. If all air is removed, the priming can be stopped by pressing "Finish Prime".



7. Prime finished - Verify there is no air in the set and liquid reaches the end of the set. Otherwise, repeat the priming process.

8. Connect the tubing set to your catheter, as instructed by your nurse.





# Starting Infusion (Repeat Last)



1. Press **"Repeat Last Infusion"**.



2. Verify program\* is correct then press **"Ok"**.



3. Press **"Start"** to begin the infusion.



4. The infusion is running.

- Each program may include different numbers and values. Verify the program on your pump fits the prescription you have from your healthcare provider.





# Stop & Resume Infusion

To stop the infusion immediately, use the **Stop** hard key.  
Contact your healthcare provider for further instructions.

## Stop Infusion



1. Press the "Stop" key.



2. The infusion is stopped.

If the pump remains paused for 30 seconds →



3. Press "OK" to fully stop.

## Resume Infusion



1. Press "Request Continue".



2. Press "OK".



3. The infusion is running.



# Restart Infusion With a New Bag

The pump alarms when the infusion ends, infusion rate changes to the programmed KVO rate. To continue the infusion with another medication container:



1. Press **"Mute"** and then press **"Ok"**.

2. Change the medication bag/  
tubing as instructed by your nurse.

3. Press **"Repeat Last Infusion"**.

4. Verify program\* is correct  
then press **"Ok"**.



5. Press **"Start"**.

6. The infusion is running.

- Your program has different numbers and values. Verify the program on your pump fits the prescription you have from your health care provider.



# Ending Infusion

At the end of the treatment, disconnect the system and turn off the pump.



1. Infusion complete.

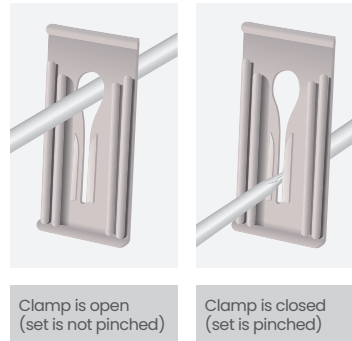

2. Close all tubing set clamps.



3. Disconnect the tubing set from your catheter.



4. Open the door.  
Push up the metal lock.



The cassette  
is discharged



5. Turn off the Pump.  
Press the "ON/OFF" key.



6. Press "OFF".

 Discard tubing and medication bag as instructed by your nurse.



# Charging The Pump

The battery can be charged during infusion. To preserve battery life, connect the pump to a wall outlet, using the power supply cord, whenever possible.

## Connecting the Power supply to the pump:



1. Align the red dot on the power supply to the arrow on the pump.

**Do not twist the connector**



2. Plug the other end of the power supply cord into a wall outlet.



## Connection to power source

**CHARGE** light:

- Blinks when charging
- Steady on when the battery is fully charged

## Disconnecting the Power supply from the pump:

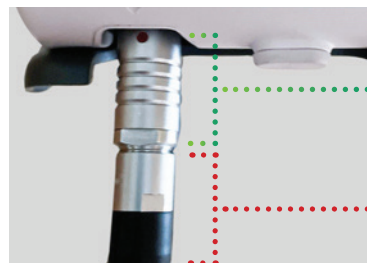

1. Pull metal connector and release it from the pump.

**Do not pull from the cord or twist the connector**



# Troubleshooting Alarms

When the pump alarms, the screen shows an error message and the suggested steps to correct such error.

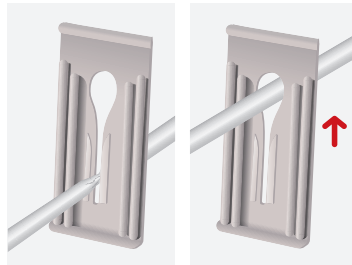

Clamp is closed  
(set is pinched)

Clamp is open  
(set is not pinched)

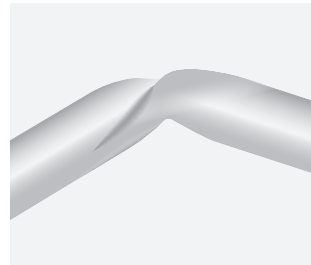

Set is Kinked



Set is straightened  
(no kinks)

1. Press **"Mute"**.

2. Follow the instruction on the screen. For occlusion - Open all tubing clamps, straighten kinks in the tubing. Make sure no other occlusions are blocking the tubing set.



3. Press **"Ok"** to dismiss the alarm.



4. Press **"Request Continue"**.

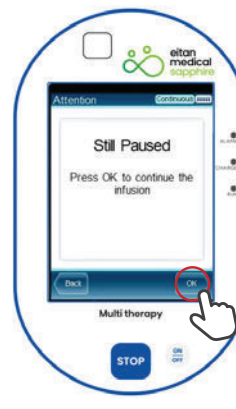

5. Press **"Ok"**.



6. The infusion is running now.

 For troubleshooting and alarms not described in this section, please contact your healthcare provider.



# Warnings

---

- The instructions presented in this manual should in no way supersede established medical protocol concerning patient care.
- Home users must be trained by their medical provider before using the Sapphire pump.
- Clinicians are advised to verify the proper route of delivery, and the patency of the infusion site.
- Avoid placing the administration set or power cord on the floor, or any other location where it can accidentally be damaged or provide a risk of strangulation, particularly due to excessive length.
- If the pump is dropped or appears to be damaged, it should not be used, contact your healthcare provider for further instructions.
- Keep the pump, the used plastic infusion containers, packaging and tubing out of the reach of children.
- Administration sets should be disposed of in a proper manner, considering the nature of residual fluid that may be contained within, in accordance with provider disposal practices.
- Do not dispose of the battery in or near fire.
- Do not use a damaged administration set or damaged set components or packaging.
- Always refer to the instructions for use that are included.
- Eitan Medical administration sets are for single patient use only and should not be sterilized or cleaned for re-use.
- Do not connect the administration set to the patient while priming.
- Do not use force when connecting the administration set to the patient.
- Always use the clamps on the administration set to occlude the administration set prior to removing the Eitan Medical administration cassette from the pump.
- Do not apply pressure or pressurized air to any outlet or tubing connected to the pump. Pressure may destroy sensitive elements.
- Do not pull or stretch the tubing in any section of the administration set when the pump is in use, nor apply pressure to the infusion container.
- Do not alter any parts or components of the pump and/or of the administration sets. Eitan Medical shall not bear any liability with regard to any damage, loss or injury caused by or to you or any other third party resulting (directly or indirectly) from the use of the Pump and/or the administrations sets not in accordance with this Patient Guide and/or your healthcare provider's instructions.



# Disclaimer

---

Other than the standard product warranty provided by Eitan Medical, Eitan Medical makes no warranties, whether express, implied, or statutory regarding or relating to the products. Eitan Medical specifically disclaims all other warranties including without limitation the implied warranties of merchantability, non-infringement and fitness for a particular purpose with respect to products, and with respect to use of any of the foregoing.

Eitan Medical does not practice medicine nor prescribe medication, dosages, volumes or delivery rates.

Eitan Medical may include certain entries, including without limitation parameter values, limit ranges, units of measure, or default settings, with the Sapphire pump, but these entries are merely suggestions that authorized medical personnel must review, accept, modify, or override. The health information contained therein is, provided for informational purposes only. All decisions regarding patient care must be made by a healthcare provider and consider the unique characteristics of each patient.

Eitan Medical disclaims and makes no warranties with respect to the result, suitability, safety or efficacy of any suggested of any decision or suggestion or diagnosing or treating or prescribing regarding patient care established by healthcare provider resulting from the use of the products. Eitan Medical specifically disclaims and you agree to assume all risk, responsibility, and liability for ensuring that any decision or diagnosing or treating or prescribing regarding patient care established by healthcare provider through use of the products complies with accepted medical practice and standards of medical care.

## **Limitation of liability**

In no event will Eitan Medical be liable for any lost profits, loss of use, business interruption, loss of data, cost of cover or indirect, special, incidental or consequential damages of any kind arising out of this guide, whether in contract or tort, including negligence, even if Eitan Medical has been advised of the possibility of such damages to the fullest extent permitted by law, Eitan Medical's aggregate liability for damages under this guide shall not, in any event, exceed an amount of USD \$10,000.





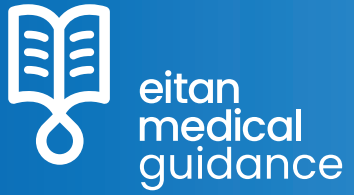

**Eitan Medical**

29 Yad Harutzim St.,  
P.O.Box 8639  
Netanya 4250529, Israel  
Tel: 972.73.2388888  
support@eitanmedical.com

**Eitan Medical North America**

65 Enterprise 3rd Floor  
Aliso Viejo, CA 92656  
Tel: 877.541.9944 | 949.303.7845  
Fax: 949.288.5482  
customerservice@eitanmedical.com

